



SEMASTOPOL

AUDIO PORT
& VOLTAGE
EXTRACTOR II

Model of 1948

OPERATOR'S MANUAL rev. 1948/2.0

SALUT

Thank you for purchasing this Xaoc Devices product. Sewastopol is a multifunction eurorack module designed for easy interfacing of external gear to your modular environment. It can export line and professional level audio, import audio from instruments and electroacoustic transducers, and analyze the incoming audio to generate voltages and triggers to control your modular system.

This is a second, vastly improved revision to the original 2014 Sewastopol, featuring a completely redesigned preamplifier circuit, better ergonomics and various other improvements.

INSTALLATION

The module requires 10hp worth of free space in the eurorack cabinet. The ribbon type power cable must be plugged into the bus board, paying close attention to polarity orientation. The red stripe indicates the negative 12V rail and is supposed to match a dot, **-12V** or **RED STRIPE** marks on both the unit and the bus board. The module itself is secured against reversed power connection, however reversing the 16-pin header **MAY CAUSE SERIOUS DAMAGE** to other components of your system, because it will short-circuit the +12V and +5V power rails. The module should be fastened by mounting the supplied screws before powering up. To better understand the device, we strongly advise the user to read through the entire manual before using the module.

MODULE OVERVIEW

Sewastopol consists of four independent blocks (see fig. 1): export attenuator and

symmetrizer **A**, import preamplifier **B**, envelope follower **C**, and voltage comparator **D**. These blocks may be used separately, but they are internally normalised thus offering a default chain for processing your modular signals through outboard gear (effects, stompboxes, signal processors), and then bringing them back to modular levels and offering several analysis options. Sewastopol facilitates using your modular system as a complex effect machine for your external gear. Its high input impedance and wide gain range allows weak guitar, microphone, and piezo transducer signals to be amplified up to modular levels.

The import and export blocks are located in the lower section of the panel. The outgoing modular signal should be patched to the **TO EXPORT** jack **1**. It is attenuated by the corresponding potentiometer **2** and transferred to the 6.3mm (1/4") TRS balanced socket **3** labeled **EXPORT/FX SEND**. The LED **4** displays the attenuated signal level and indicates possible clipping. The external signal to be introduced to your modular should be patched to the 6.3mm (1/4") jack **5** labeled **IMPORT/FX RETURN**. The gain knob **6** sets the amount of amplification over a wide range, while the LED **7** indicates possible clipping. The amplified input signal is available in the **IMPORTED** jack **8**.

The upper part of the front panel offers controls for the signal analysis blocks. The envelope follower input jack **9** labeled **FOLLOW** is internally normalised to the output of the import block, but it allows for directly patching other signals. Before processing by the follower, the input signal may be conditioned by an optional highpass filter switched by the toggle **10** labeled **LOW END CUT**. The fil-

fig. 1

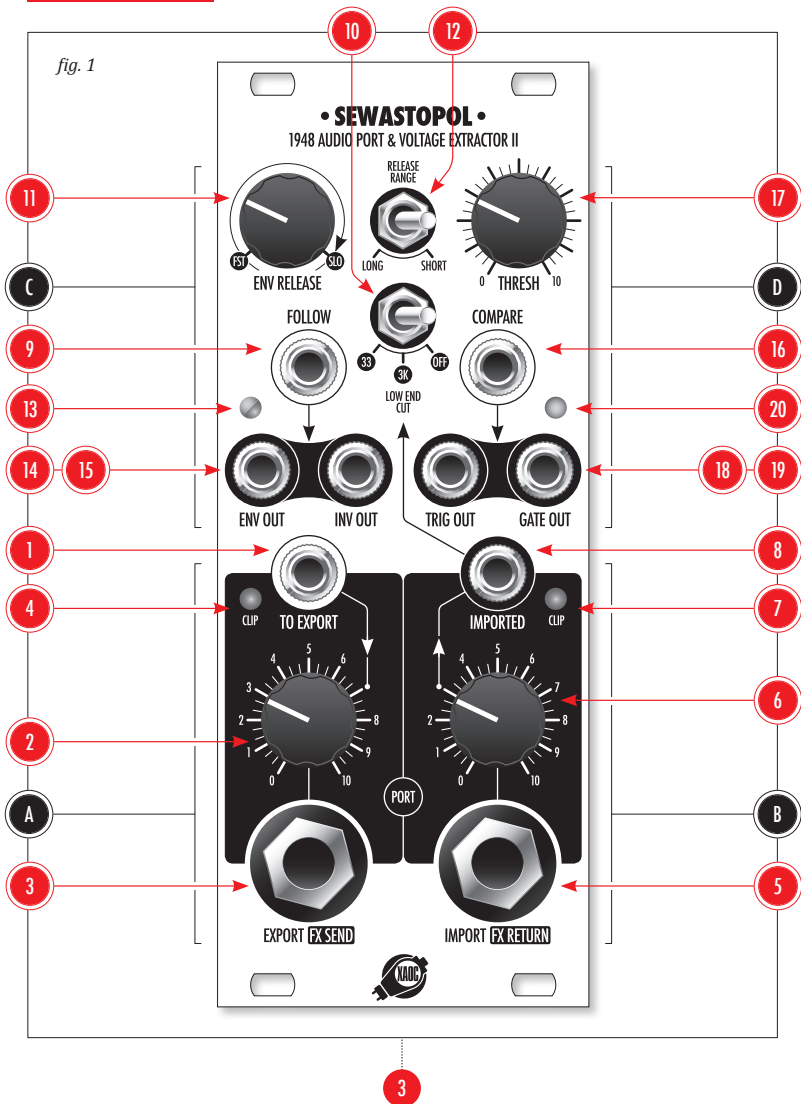

ter affects the operation of the follower only, while the signal delivered to the **IMPORTED** remains full-band.

The envelope follower generates a unipolar control voltage that reflects the amplitude of the input signal. It reacts instantly to every increase of the amplitude (especially at transients), and the output CV decays with a rate set by the **ENV RELEASE** knob 11 and the **RELEASE RANGE** toggle 12. A multicolor LED 13 monitors the generated envelope. This control voltage is available in both positive and negative (inverted) polarity at the corresponding jacks 14 15.

The comparator input jack 16 labeled **COMPARE** is internally normalised to the output of the envelope follower, but it can also be used with other signals. It works in a straightforward way: the input is compared with the value set by the **THRESH** knob 17.

Each time the threshold is exceeded, a short trigger impulse is produced and the gate goes high. These two signals are available at the corresponding jacks 18 19 while the LED 20 displays gate activity.

USING THE MODULE

To process modular signals through your outboard gear, arrange an external chain of desired processors to be included in your patch and connect it between the **FX SEND** and **FX RETURN** (fig. 6). Remember that modular signals are way too hot for some studio gear (which can eventually cause damage), so attenuation is important. The import pre-amplifier offers a wide range of gain settings (0dB to +60dB), therefore you must carefully set the knob unless you want to exploit the screaming distortion of the preamp.

You can use Sewastopol as a general output to an outboard mixer, amp, or computer interface. To comfortably mix or record the signal from the modular system, patch a shielded cable from the **EXPORT** jack to your equipment. Sewastopol features a fully balanced output, so if the device has a balanced input it will greatly benefit from using a symmetric TRS cable.

Sewastopol provides an easy way to import external signals to your modular system from a guitar, a standalone synth, a drum machine, or any other instrument or microphone. Just patch the shielded cable with

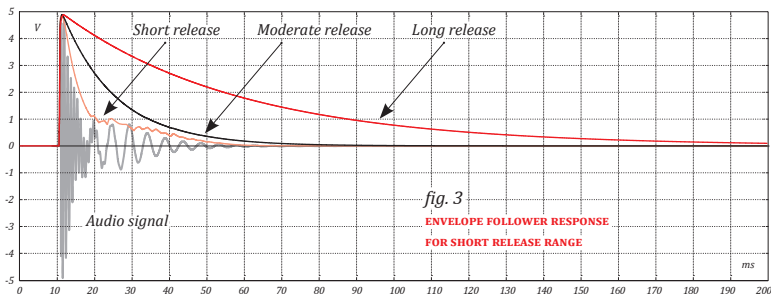

fig. 3
ENVELOPE FOLLOWER RESPONSE
FOR SHORT RELEASE RANGE

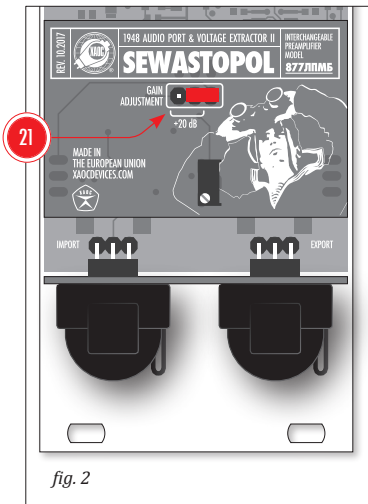

fig. 2

a 6.3mm (1/4") plug to the **IMPORT** jack and carefully set the gain. The preamplifier accepts very weak to very hot signals and features high input impedance (10M Ω) so that it sounds great with coil and piezoelectric transducers. It offers a gain of up to +60dB on the knob plus an optional boost of

+20dB set via jumper **21** on the back (fig. 2). Be aware that at high gain settings the preamplifier may be sensitive to all kinds of noises from other devices, switching power supplies and transformers, as well as hum, which is often caused by poor shielding of the input cable.

The envelope follower in Sewastopol is a unique circuit that offers both rapid reaction to transients and smoothed response to amplitude fluctuations (fig. 3, 4). As opposed to followers based on rectification and smoothing (which results in lags or unwanted ripples in the output voltage), Sewastopol makes use of a bipolar peak detector whose output is held until a subsequent waveform peak arrives. The response for a rapid increase of amplitude (often associated with transients) is nearly instantaneous. The output value may be held for a longer time, depending on the setting of the **ENV RELEASE** knob (fig. 3). During this time the output CV decays to zero unless there is another peak or some other component detected (like noise, or hum, or even an inaudible DC offset). If such a component occurs, the follower will continue updating its output CV as long as this component remains present (fig. 4).

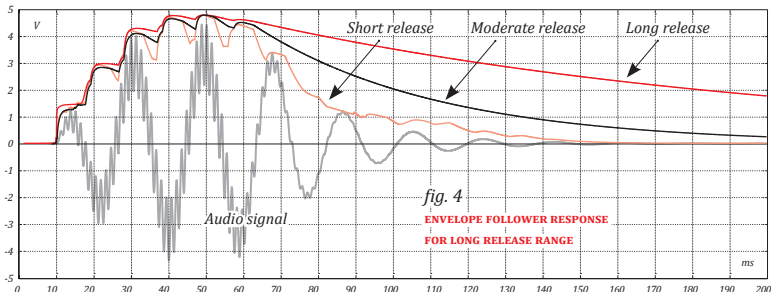
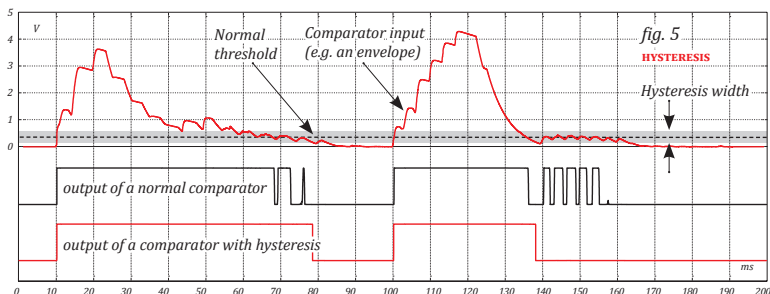

fig. 4
ENVELOPE FOLLOWER RESPONSE
FOR LONG RELEASE RANGE



A proper setting of the release time is crucial for obtaining a musically useful CV signal that is not too rough and not too sloppy. The knob and range switch offer a wide range of settings suitable for extremely short and dry transients as well as long tails of reverbs. While extreme settings are rarely useful in “normal” applications, they can be creatively exploited for unusual effects.

When operating on complex music material, the results may be dominated by the presence of strong-low frequency components. If your aim is to detect percussive elements rather than the bass, set the **LOW END CUT** filter to 33Hz to attenuate low frequencies, or to 3kHz to attenuate low and midrange frequencies. Keep in mind that removing low frequencies significantly reduces the overall amplitude of the follower input.

The comparator block is optimized for generating note-on-like gate signals and corresponding trigger signals in response to the presence of sounds at the **IMPORT** jack (and analyzed by the envelope detector). Please note that a comparator operating directly on audio signals would produce a stream of rapid impulses corresponding to the shape

of the waveform—that’s why the connection is better left normalled to the envelope output.

The threshold potentiometer must be carefully adjusted to obtain a reliable note detection each time the parameters of the envelope follower are changed. In order to minimize erratic multiple firing, the comparator is equipped with a narrow hysteresis circuit. Different thresholds are applied for increasing and decreasing voltage, so that any changes within a small range are ignored (fig. 5).

EXCHANGEABLE PREAMPLIFIER

The preamplifier is located on a separate detachable board (fig. 2) and can be exchanged with a different circuit, for example a low impedance, or tube-based preamp. This edition of Sewastopol ships with a universal solid-state preamplifier model “877/ЛПМБ”, based on a symmetric JFET input stage and a very low noise operational amplifier. This preamp model is our best effort to achieve very high input impedance and gain while keeping noise at a minimum level. Additional preamp models may be available in the future. •

fig. 6

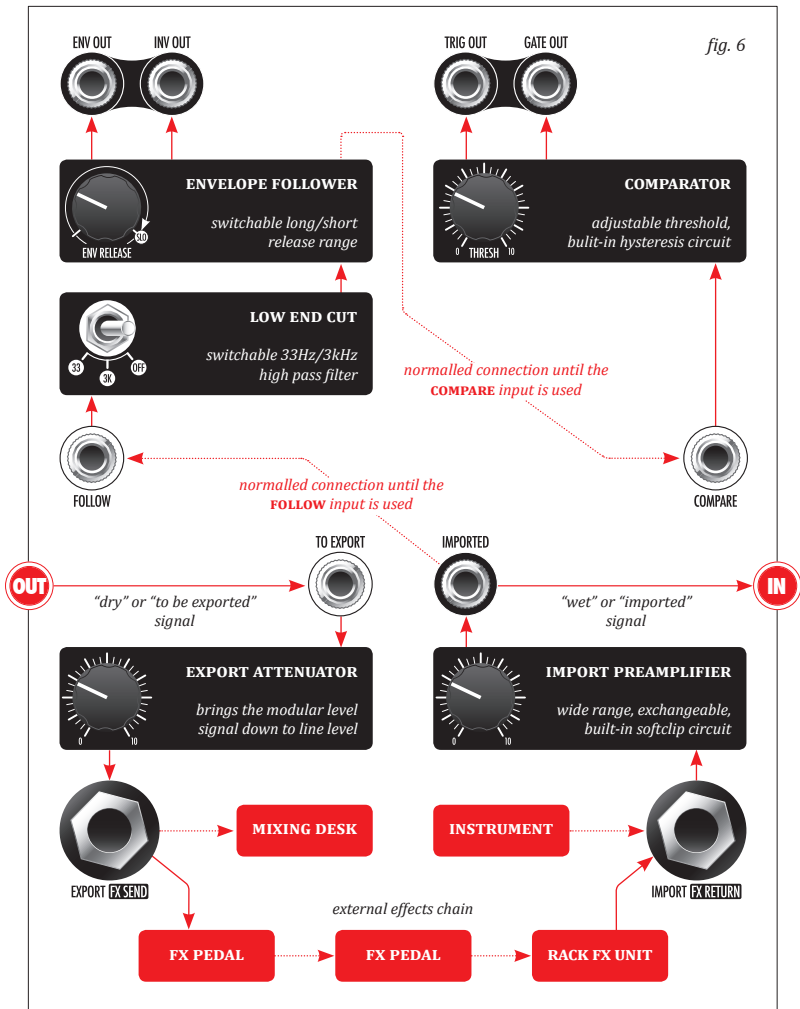

WARRANTY TERMS

XAOC DEVICES WARRANTS THIS PRODUCT TO BE FREE OF DEFECTS IN MATERIALS OR WORKMANSHIP, AND TO CONFORM WITH THE SPECIFICATIONS AT THE TIME OF SHIPMENT FOR A PERIOD OF ONE YEAR FROM THE DATE OF PURCHASE. DURING THAT PERIOD ANY MALFUNCTIONING OR DAMAGED UNITS WILL BE REPAIRED, SERVICED, AND CALIBRATED ON A RETURN-TO-FACTORY BASIS. THIS WARRANTY DOES NOT COVER ANY PROBLEMS RESULTING FROM DAMAGES DURING SHIPPING, INCORRECT INSTALLATION OR POWER SUPPLY, IMPROPER WORKING ENVIRONMENT, ABUSIVE TREATMENT OR ANY OTHER OBVIOUS USER-INFLICTED FAULT.

LEGACY SUPPORT

IF SOMETHING WENT WRONG WITH A XAOC PRODUCT AFTER THE WARRANTY PERIOD IS OVER, NO NEED TO WORRY, AS WE'RE STILL HAPPY TO HELP! THIS APPLIES TO ANY DEVICE, WHEREVER AND WHENEVER ORIGINALLY ACQUIRED. HOWEVER, IN SPECIFIC CASES, WE RESERVE THE RIGHT TO CHARGE FOR LABOR, PARTS AND TRANSIT EXPENSES WHERE APPLICABLE.

RETURN POLICY

THE DEVICE INTENDED FOR REPAIR OR REPLACEMENT UNDER WARRANTY NEEDS TO BE SHIPPED IN THE ORIGINAL PACKAGING ONLY, SO PLEASE KEEP IT JUST IN CASE. ALSO, A FILLED RMA FORM MUST BE INCLUDED. XAOC DEVICES CAN NOT TAKE ANY RESPONSIBILITY FOR DAMAGES CAUSED DURING TRANSPORT. PRIOR TO SENDING US ANYTHING, PLEASE CONTACT US AT SUPPORT@XAOCDEVICES.COM. NOTE THAT ANY UNSOLICITED PARCEL WILL BE REJECTED AND RETURNED!

GENERAL INQUIRIES

FOR USER FEEDBACK SUGGESTIONS, DISTRIBUTION TERMS, AND JOB POSITIONS FEEL FREE TO CONTACT XAOC DEVICES AT INFO@XAOCDEVICES.COM. PLEASE VISIT THE XAOCDEVICES.COM FOR INFORMATION ABOUT THE CURRENT PRODUCT LINE, USER MANUALS, FIRMWARE UPDATES, TUTORIALS, AND MERCHANDISE.

WORKING CLASS ELECTRONICS®

EASTERN BLOC TECHNOLOGIES



MADE IN THE EUROPEAN UNION

ALL RIGHTS RESERVED. CONTENT COPYRIGHT © 2017 XAOC DEVICES. COPYING, DISTRIBUTION OR ANY COMMERCIAL USE IN ANY WAY IS STRICTLY PROHIBITED AND REQUIRES THE WRITTEN PERMISSION BY XAOC DEVICES. SPECIFICATIONS ARE SUBJECT TO CHANGE WITHOUT PRIOR NOTICE.

MAIN FEATURES

Audio input and output interface

External effects audio port

Versatile envelope follower with two wide ranges of operation and low-cut filter

Precise voltage comparator with hysteresis circuit for gate and trigger accuracy

Exchangeable preamplifier

Balanced output

Internal normalizations

TECHNICAL DETAILS

Eurorack synth compatible

10hp, 36mm deep

Maximum current draw: +100mA / -70mA

Reverse power protection